

LEGEND	
S	SEWER
G	GAS
W	POTABLE WATER
SWD	STORM WATER DRAIN
	GRAVEL TRENCH - (rail ballast nominal size 50mm)
	BALANCING PIPE - 90mm $\phi$ (slotted section within gravel trench)
	BALANCING PIPE - 90mm $\phi$ (solid pipe section between gravel trenches)



GENERAL NOTES:  
 1 AT HIGHLY CONSTRAINED SITES, GRAVEL TRENCHES CAN BE MODIFIED IN THE FOLLOWING WAYS:  
 - REDUCED OFFSET OF 0.75 M FROM TREE CENTRELINE  
 - DIMENSION 10 M LONG x 0.6 M WIDE x 0.75 M DEEP

REV	DESCRIPTION	APP'D	DATE
A	PRELIMINARY ISSUE	HV	27.09.18
B	REVISED DESIGN	JMCL	09.10.18
C	REVISED DESIGN - REISSUE	JMCL	31.10.18
D	REVISED DESIGN - REISSUE	JMCL	01.03.19

REV	DESCRIPTION	APP'D	DATE
A	PRELIMINARY ISSUE	HV	27.09.18
B	REVISED DESIGN	JMCL	09.10.18
C	REVISED DESIGN - REISSUE	JMCL	31.10.18
D	REVISED DESIGN - REISSUE	JMCL	01.03.19



Aluvium Consulting Australia  
 Pty. Ltd.  
 ABN 76 151 119 792  
 Lvl 1, 105-115 Dover Street  
 Cremorne Vic. 3121  
 T 61 3 9421 2332  
 www.aluvium.com.au

DESIGNED: H. VIRAHSAWAMY  
 DRAWN: K. STANHOPE  
 CHECKED: J. MCLEAN  
 APPROVED: [Signature]  
 PROJECT No: P17805

MELTON CITY COUNCIL  
 PASSIVE STREET TREE IRRIGATION  
 GRAVEL TRENCH (KERB INLET DIVERSION)  
 PLAN

REVISION: D  
 SHEET No.: 3  
 ORIGINAL SIZE: A1  
 SCALE: 1:20 (A1) or 1:40 (A3)  
 DATE: m. AHD (MGA 255)

NOTES:  
 TOP OF GRAVEL TRENCH TO BE LINED WITH NON-WOVEN GEOTEXTILE MATERIAL AS SHOWN TO PREVENT FINE MIGRATION INTO THE TRENCH  
 PASSIVE IRRIGATION PIPES AND FITTINGS TO BE 90 MM DIAMETER PVC SEWER CLASS  
 ALL PVC JOINTS TO BE SEALED WITH SOLVENT CEMENT  
 ALL GRASSSED AREAS TO BE TOP DRESSED WITH 100 MM TOPSOIL AND SEEDED AS SPECIFIED  
 SERVICE DEPTHS AND LOCATIONS ARE INDICATIVE ONLY

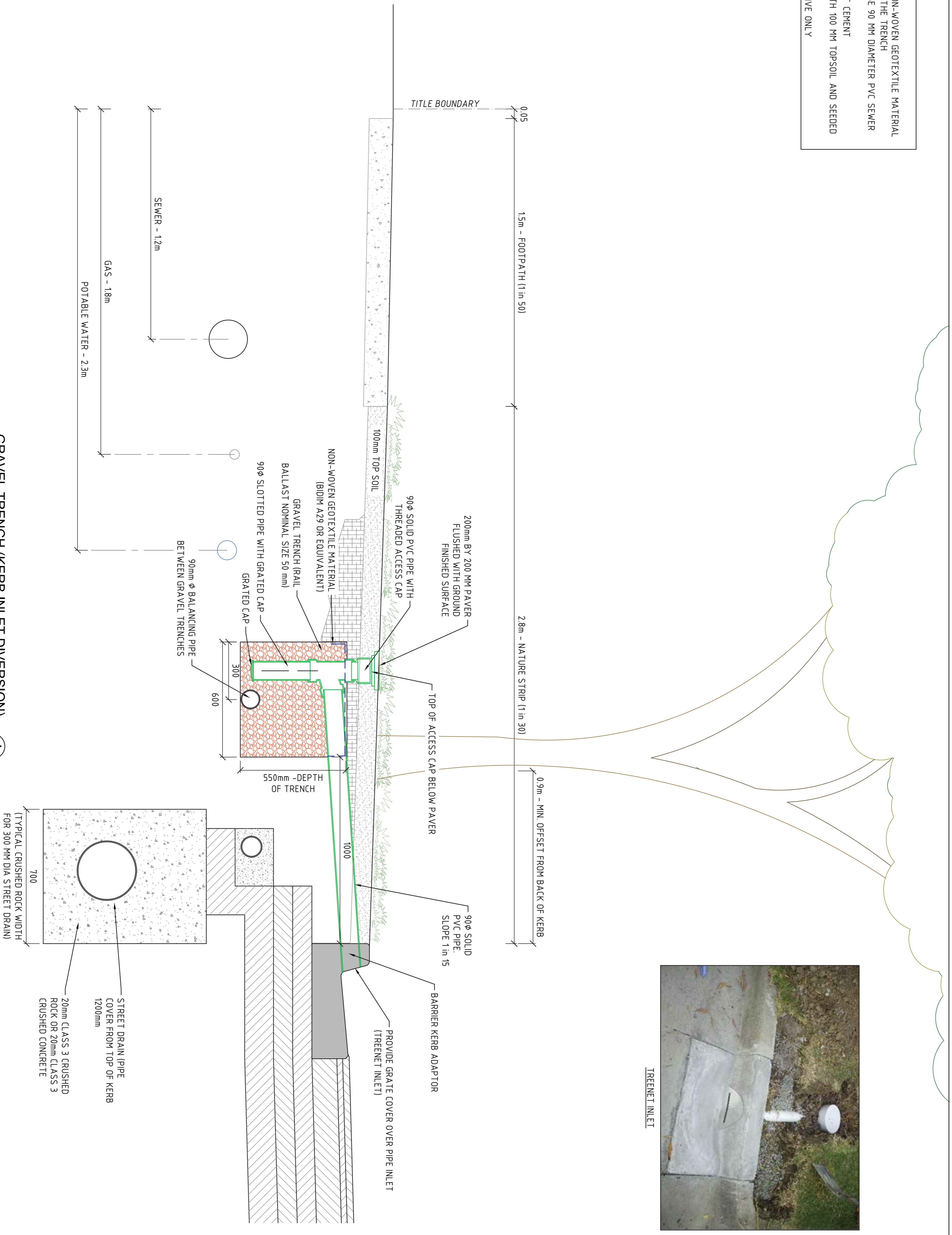

TREENET INLET

GRAVEL TRENCH (KERB INLET DIVERSION)  
 1:10 (A1)  
 A  
 3

REV	DESCRIPTION	APP'D	DATE
A	PRELIMINARY ISSUE	HV	27.09.18
B	REVISED DESIGN	JMCL	09.10.18
C	REVISED DESIGN - REISSUE	JMCL	31.10.18
D	REVISED DESIGN - REISSUE	JMCL	30.11.18
E	REVISED DESIGN - REISSUE	JMCL	01.03.19

**CITY OF MELTON**

**aluvium**

Aluvium Consulting Australia  
 Pty. Ltd.  
 ABN 76 151 119 792  
 Lvl 1, 105-115 Dover Street  
 Cremorne Vic. 3121  
 T 61 3 9421 2332  
 www.aluvium.com.au

DESIGNED: H. VIRASAWAMY  
 DRAWN: K. STANHOPE  
 CHECKED: J. MCLEAN  
 APPROVED: [Signature]  
 PROJECT No: P17805

**MELTON CITY COUNCIL**  
 PASSIVE STREET TREE IRRIGATION  
 GRAVEL TRENCH (KERB INLET DIVERSION)  
 CROSS SECTION

REVISION: E  
 SHEET No.: 4  
 ORIGINAL SIZE: A1  
 SCALE: 1:10 (A1) or 1:20 (A3)  
 DATE: m. AHD (MGA 255)  
 0.1 0.2 0.4 0.6m

LEGEND	
S	SEWER
G	GAS
W	POTABLE WATER
—	STORM WATER DRAIN
SWD	STORM WATER DRAIN - (ballast nominal size 50mm)
—	GRAVEL TRENCH - (fine blue metal gravel 20mm)
—	INFILTRATION ZONE
—	ROCK PAD



- GENERAL NOTES:**
- 1 INFILTRATION SURFACE DOES NOT HAVE TO BE IN THE MIDDLE OF THE GRAVEL TRENCH, AS SHOWN. TRENCH CAN BE MOVED TO LEFT OR RIGHT DEPENDING ON SITE CONSTRAINTS.
  - 2 TREE TO BE PLANTED ADJACENT TO INFILTRATION SURFACE WITH A MINIMUM OF 0.75m OFFSET FROM TRENCH
  - 3 AT SITES WHERE SPACE IS HIGHLY CONSTRAINED, GRAVEL TRENCH CAN BE CONFIGURED TO BE 2m LONG x 0.9m WIDE. INFILTRATION ZONE DIMENSION TO REMAIN AT 1.0m LONG x 0.6m WIDE. TREE OFFSET FROM GRAVEL TRENCH OF 0.75m TO BE MAINTAINED.

REV	DESCRIPTION	APP'D	DATE
A	PRELIMINARY ISSUE	HV	27.09.18
B	REVISED DESIGN - REISSUE	JMCL	09.10.18
C	REVISED DESIGN - REISSUE	JMCL	31.10.18
D	REVISED DESIGN - REISSUE	JMCL	01.03.19

REV	DESCRIPTION	APP'D	DATE
A	PRELIMINARY ISSUE	HV	27.09.18
B	REVISED DESIGN - REISSUE	JMCL	09.10.18
C	REVISED DESIGN - REISSUE	JMCL	31.10.18
D	REVISED DESIGN - REISSUE	JMCL	01.03.19



DESIGNED:	DRAWN:	CHECKED:	APPROVED:
H. VIRASAWAMY	K. STANHOPE	J. MCLEAN	
Aluvium Consulting Australia Pty. Ltd. ABN 76 151 119 792 Lvl 1, 105-115 Dover Street Cremorne Vic. 3121 T 61 3 9421 2332 www.aluvium.com.au			
PROJECT No:	PROJECT No:	PROJECT No:	PROJECT No:
PT805	PT805	PT805	PT805

REVISION:	SHEET No.:	ORIGINAL SIZE:	SCALE:
D	5	A1	1:20 (A1) or 1:40 (A3)
<b>MELTON CITY COUNCIL</b> <b>PASSIVE STREET TREE IRRIGATION</b> <b>GRAVEL TRENCH (KERB CUT SURFACE INFILTRATION)</b> <b>PLAN</b>			

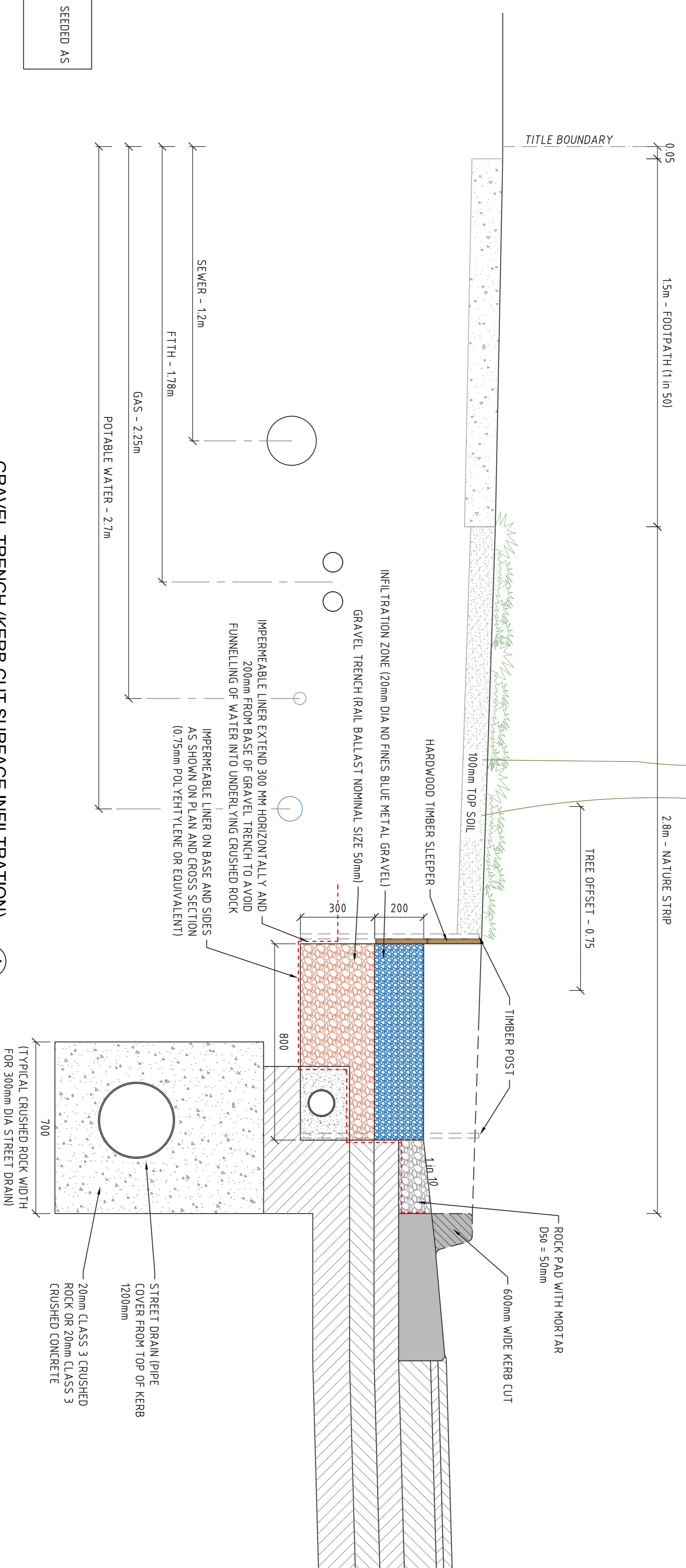
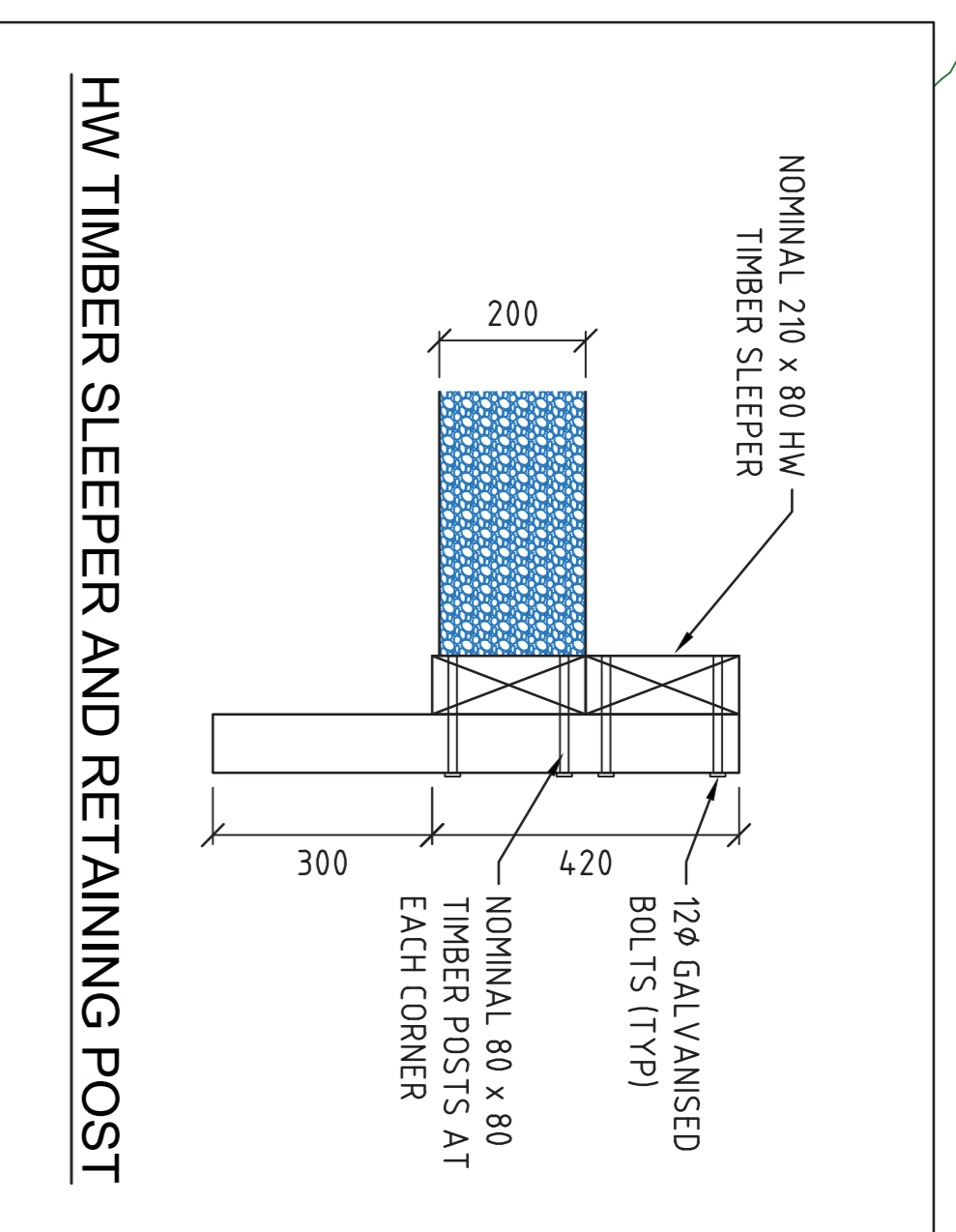
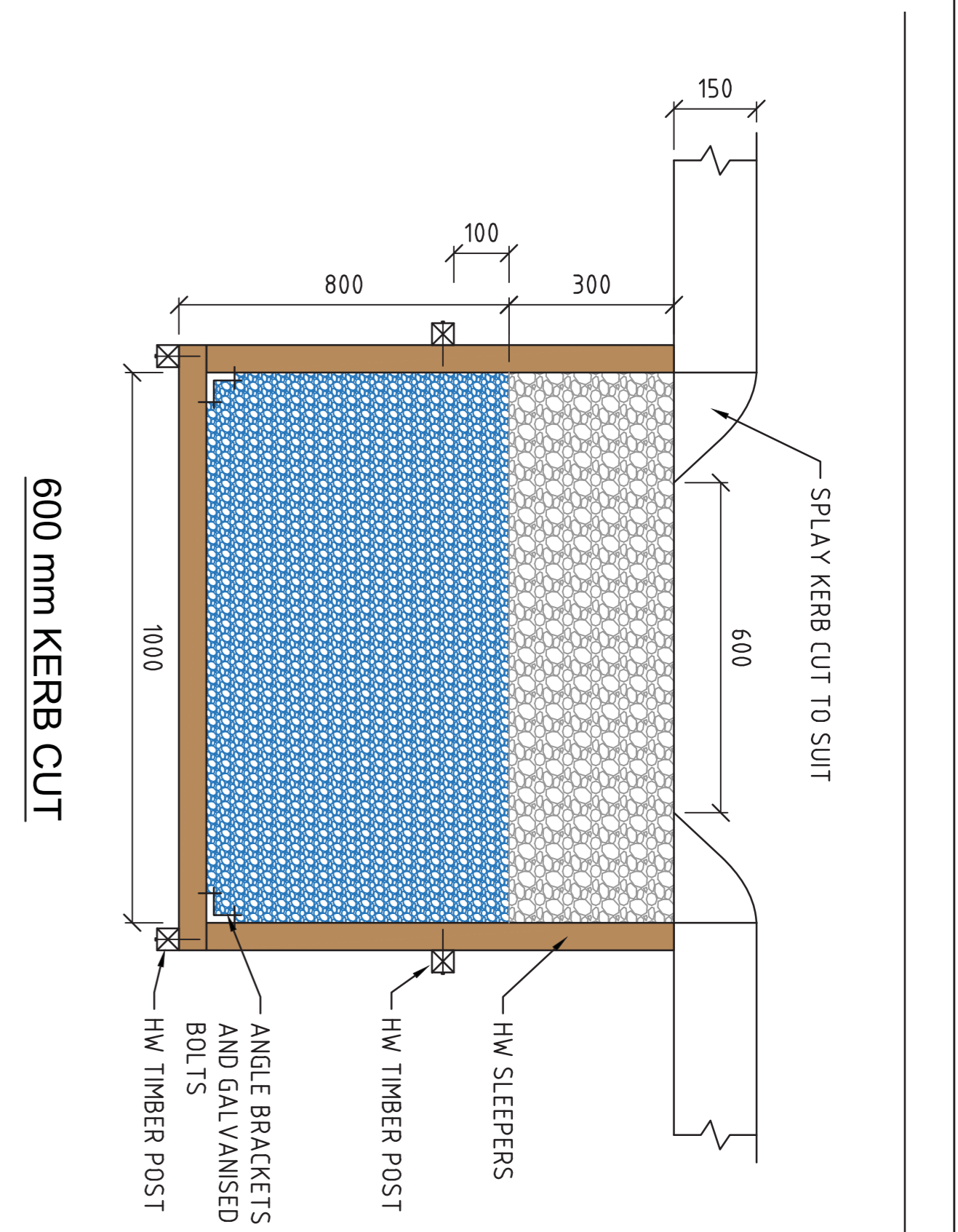

**NOTES:**  
 ALL GRASSED AREAS TO BE TOP DRESSED WITH 100mm TOPSOIL AND SEEDED AS SPECIFIED  
 SERVICE DEPTHS ARE INDICATIVE ONLY

REV	DESCRIPTION	APP'D	DATE
A	PRELIMINARY ISSUE	HV	27.09.18
B	REVISED DESIGN	JMCL	09.10.18
C	REVISED DESIGN - REISSUE	JMCL	31.10.18
D	REVISED DESIGN - REISSUE	JMCL	30.11.18
E	REVISED DESIGN - REISSUE	JMCL	01.03.19

**GRAVEL TRENCH (KERB CUT SURFACE INFILTRATION)**  
 1:10 (A1)  
 5

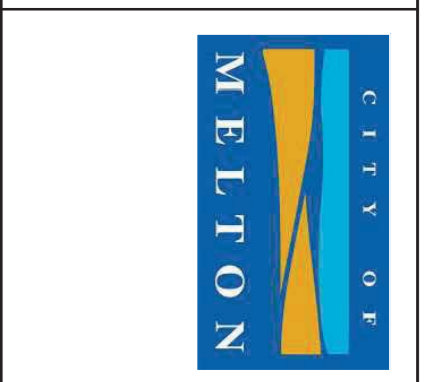

**aluvium**  
 Aluvium Consulting Australia  
 Pty. Ltd.  
 ABN 76 151 119 792  
 Lvl 1, 105-115 Dover Street  
 Cremorne Vic 3121  
 T 61 3 9421 2332  
 www.aluvium.com.au

DESIGNED: H. VIRASAWAMY  
 DRAWN: K. STANHOPE  
 CHECKED: J. MCLEAN  
 APPROVED: [Signature]

PROJECT No: P17895

**MELTON CITY COUNCIL**  
 PASSIVE STREET TREE IRRIGATION  
 GRAVEL TRENCH (KERB CUT SURFACE INFILTRATION)  
 CROSS SECTION

REVISION: E  
 SHEET No.: 6  
 ORIGINAL SIZE: A1  
 SCALE: 1:10 (A1) or 1:20 (A3)  
 DATUM: m AHD (MGA 255)