

PLAN OF SUBDIVISION UNDER SECTION 35(8) OF THE SUBDIVISION ACT 1988				LRS USE ONLY EDITION		PLAN NUMBER PS 838540T	
LOCATION OF LAND PARISH: KOROROIT TOWNSHIP: SECTION: C CROWN ALLOTMENT: 12 (PART) CROWN PORTION: TITLE REFERENCES: VOL 11168 FOL 187 LAST PLAN REFERENCE: LOT 1 ON PS 611313W POSTAL ADDRESS: 83-105 ABEY ROAD (at time of subdivision) COBBLEBANK, VIC 3338 MGA CO-ORDINATES: E: 287659 ZONE: 55 (of approx. centre of plan) N: 5824065 DATUM: GDA94				COUNCIL NAME: MELTON CITY COUNCIL			
ROADS AND RESERVES VEST IN THE COUNCIL/BODY/ PERSON NAMED WHEN THE APPROPRIATE VESTING DATE IS RECORDED OR TRANSFER REGISTERED. ONLY ROADS AND RESERVES MARKED THUS (%) VEST UPON REGISTRATION OF THIS PLAN				NOTATIONS			
VESTING OF ROADS OR RESERVES							
IDENTIFIER		COUNCIL/BODY/PERSON					
RESERVE No.1		MELTON CITY COUNCIL					
NOTATIONS							
DEPTH LIMITATION 15.24m BELOW THE SURFACE							
TANGENT POINTS ARE SHOWN THUS:				SURVEY: THIS PLAN IS BASED ON SURVEY THIS SURVEY HAS BEEN CONNECTED TO PERMANENT MARKS No(s). KOROROIT PM77 & DJERRIWARRH PM177 IN PROCLAIMED SURVEY AREA No. --			
EASEMENT INFORMATION							
EASEMENTS MARKED (-) ARE EXISTING EASEMENTS EASEMENTS MARKED (+) ARE CREATED UPON REGISTRATION OF THIS PLAN. EASEMENTS MARKED (*) ARE CREATED WHEN THE APPROPRIATE VESTING DATE IS RECORDED OR TRANSFER REGISTERED EASEMENTS MARKED (#) ARE REMOVED WHEN APPROPRIATE VESTING DATE IS RECORDED OR TRANSFER REGISTERED							
LEGEND: A - APPURTENANT E - ENCUMBERING EASEMENT R - ENCUMBERING EASEMENT (ROAD)							
SYMBOL	EASEMENT REFERENCE	PURPOSE	WIDTH (METRES)	ORIGIN	LAND BENEFITED OR IN FAVOUR OF		
(-)	E-1	DRAINAGE	SEE PLAN	PS 611313W	LAND IN PS 611313W MELTON CITY COUNCIL		
Breese Pitt Dixon Pty Ltd 1/19 Cato Street Hawthorn East Vic 3123 Ph: 8823 2300 Fax: 8823 2310 www.bpd.com.au info@bpd.com.au			REF: 10398 VERSION: 1 LICENSED SURVEYOR: DAMIAN J SMALE		ORIGINAL SHEET SIZE A3	SHEET 1 OF 3 SHEETS	
CHECKED		DATE: 30/06/20					

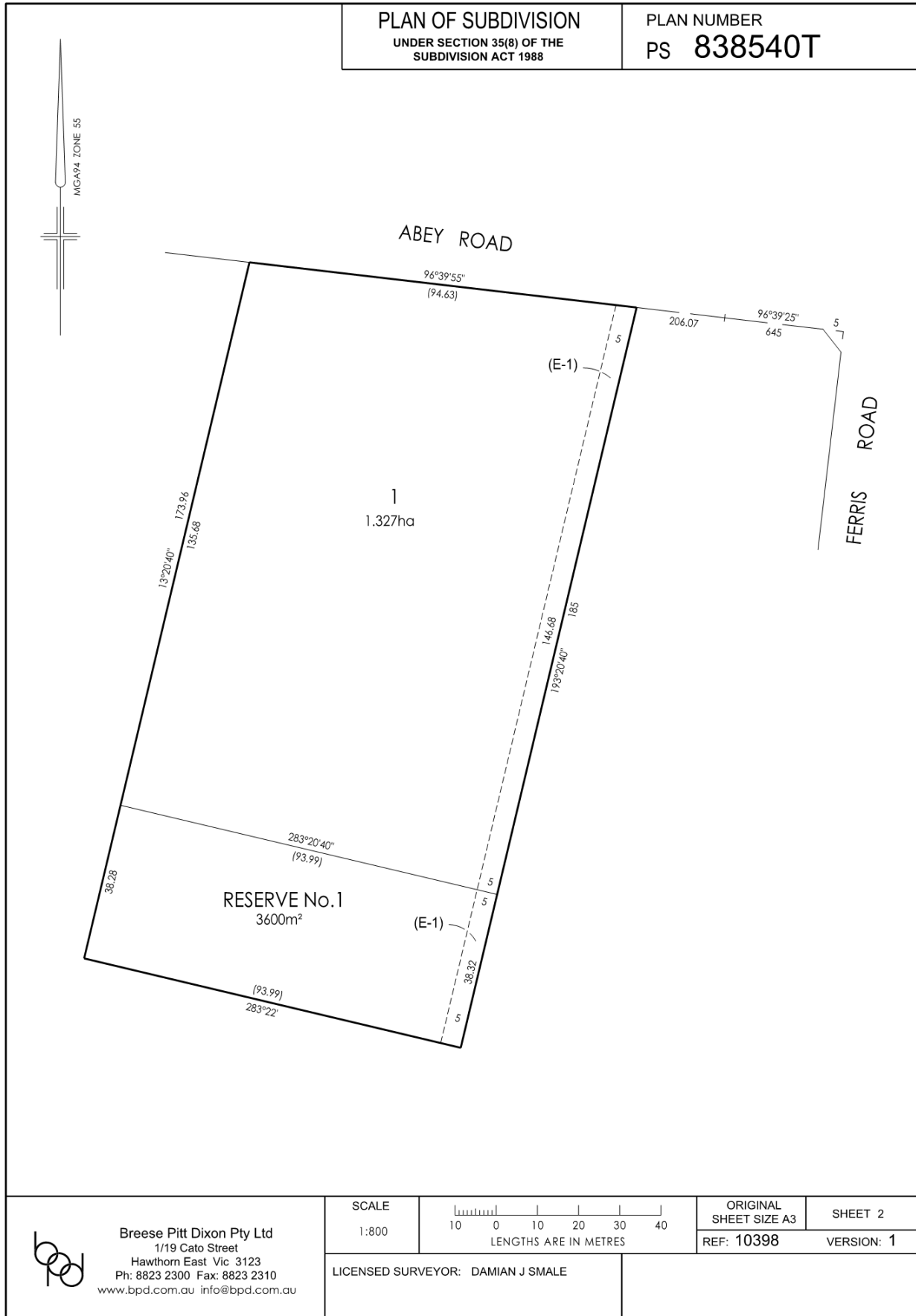
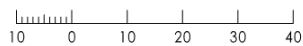

Breese Pitt Dixon Pty Ltd
 1/19 Cato Street
 Hawthorn East Vic 3123
 Ph: 8823 2300 Fax: 8823 2310
 www.bpd.com.au info@bpd.com.au

SCALE		ORIGINAL SHEET SIZE A3	SHEET 2
1:800	LENGTHS ARE IN METRES	REF: 10398	VERSION: 1

LICENSED SURVEYOR: DAMIAN J SMALE

PLAN OF SUBDIVISION
UNDER SECTION 35(8) OF THE
SUBDIVISION ACT 1988

PLAN NUMBER
PS 838540T

VESTING DATES AND TRANSFER REGISTRATION DATES OF ACQUIRED LAND

Land affected	Land acquired by compulsory process			Land acquired by agreement	LRS reference of transfers or notifications of vesting dates	Assistant Registrar of Titles signature	
	Vesting date	Government Gazette		Date of recording of vesting date			Date of registration of transfer
		Page	Year				
RESERVE No.1	--	--	--	--			



Breese Pitt Dixon Pty Ltd
1/19 Cato Street
Hawthorn East Vic 3123
Ph: 8823 2300 Fax: 8823 2310
www.bpd.com.au info@bpd.com.au

SCALE

REF: 10398

VERSION: 1

ORIGINAL SHEET SIZE A3

SHEET 3

LICENSED SURVEYOR: DAMIAN J SMALE