

PLAN OF SUBDIVISION		EDITION 1	PS 749153W	
LOCATION OF LAND PARISH: Djerriwarrh TOWNSHIP: - SECTION: 3 CROWN ALLOTMENT: B (Part) CROWN PORTION: - TITLE REFERENCE: Vol. 9932 Fol. 755 LAST PLAN REFERENCE: Lot 89 on LP213798C POSTAL ADDRESS: 2 Aviator Place, Brookfield, 3338 (at time of subdivision) MGA CO-ORDINATES: E: 284 940 ZONE: 55 (of approx centre of land N: 5 824 360 GDA 94 in plan)		COUNCIL NAME : Melton City Council		
VESTING OF ROADS AND/OR RESERVES		NOTATIONS		
IDENTIFIER	COUNCIL/BODY/PERSON			
Nil	Nil			
NOTATIONS		<div style="border: 1px solid black; padding: 5px;"> <p>WARNING - Preliminary Subdivision Plan</p> <p>Subject to council and Service Authorities approvals.</p> <p>This plan is a Preliminary Subdivision Plan based upon design drawings provided by our client.</p> <p>Boundaries and dimensions are subject to change on the Final Subdivision Plan.</p> </div>		
DEPTH LIMITATION : Does not apply				
SURVEY: This plan is based on survey. STAGING: This is not a staged subdivision. Planning Permit No. This survey has been connected to permanent marks No(s). In Proclaimed Survey Area No.				
EASEMENT INFORMATION				
LEGEND: A - Appurtenant Easement E - Encumbering Easement R - Encumbering Easement (Road)				
Easement Reference	Purpose	Width (Metres)	Origin	Land Benefited/In Favour Of
E - 1	Drainage and Sewerage	3.00	LP213798C	Lots on LP213798C
E - 2	Carriageway	See Plan	This Plan	Lot 1 on PS749153W
Di MASE BERRY & Co Pty Ltd 142A Sydney Road, Brunswick 3056 Tel 9387 7577 Fax 9387 8813		SURVEYORS FILE REF: :13456 VERSION No. 3PSP JN		ORIGINAL SHEET SIZE: A3 SHEET 1 OF 2

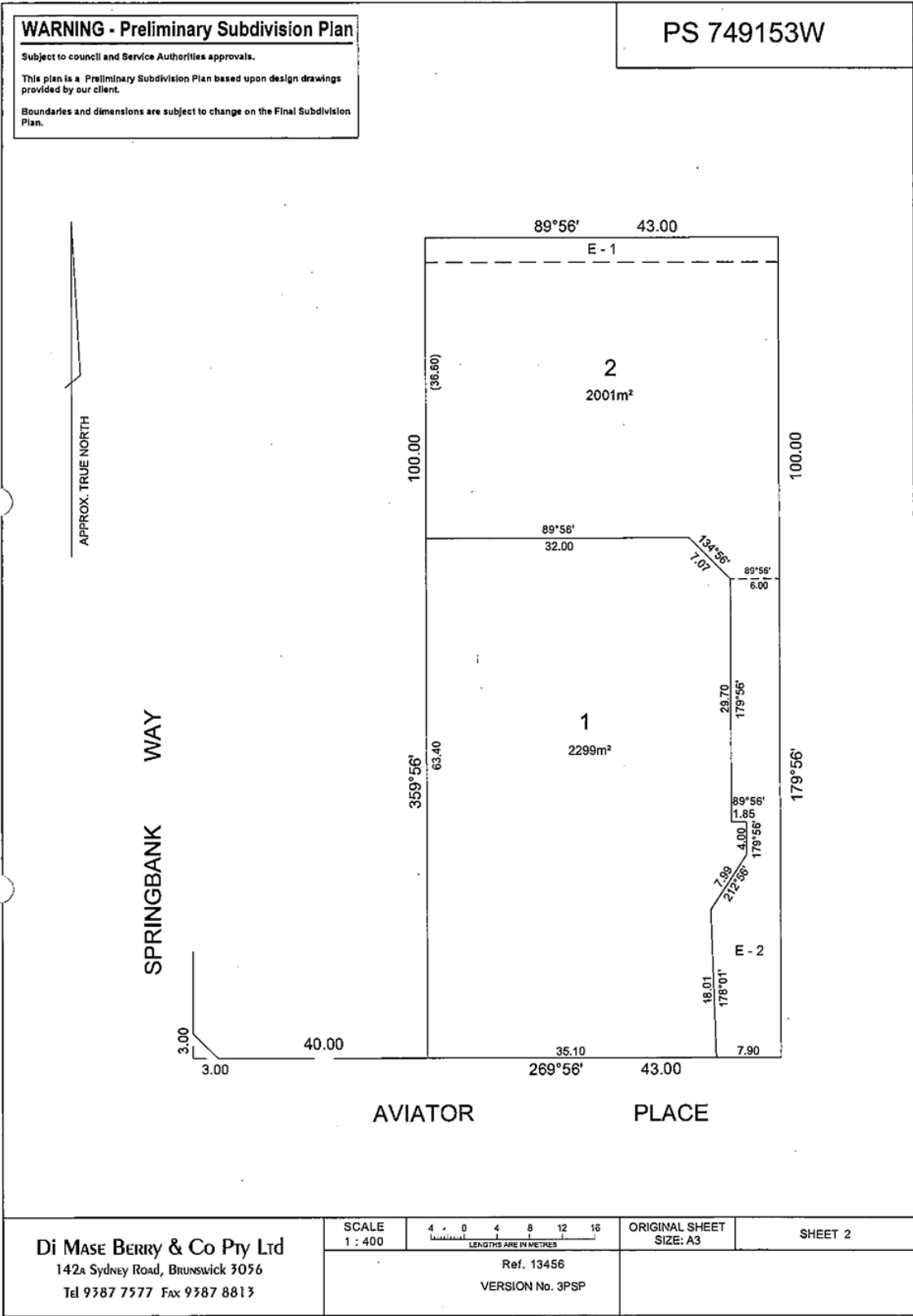

<p>Di Mase Berry & Co Pty Ltd 142a Sydney Road, BRUNSWICK 3056 Tel 9387 7577 Fax 9387 8813</p>	<p>SCALE 1 : 400</p>	<p>LENGTHS ARE IN METRES</p>	<p>ORIGINAL SHEET SIZE: A3</p>	<p>SHEET 2</p>
	<p>Ref. 13456 VERSION No. 3PSP</p>			